

KLEMMFILZ

Product data sheet

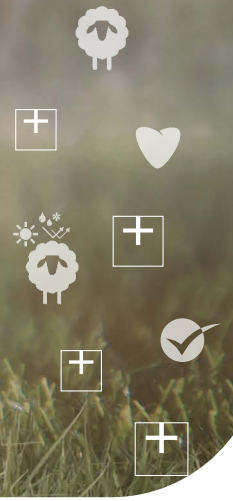

Item number
Density
Raw material
Application

KF-03000BR24
30 kg/m³
100% wool sustainable, durable, recyclable, without synthetic additives
Interior finishing, room air renovation – Partition walls, installation level, Suspended (acoustic-)ceiling



PRODUCT DESCRIPTION

- The clamping felt roll is the **high-performance insulation** with an exceptional thermal and sound insulation effect.
- Improved **sound-absorbing effect** in partition walls.
- For clamping between supporting structures, fasten mechanically.



WOOL PROTECTION

- **IONIC PROTECT®** biocide-free wool protection, long-term tested by EAD/CUAP standards and patented procedure.
- Is a slight alteration of the molecular protein structure of the wool fibre through a **plasma-ion treatment**. This specific process is unique as it permanently prevents the wool from being a nutritional source for wool parasites.
- Through the wool protection, our products have an **unlimited shelf-life**.



INSTALLATION

- **Quick installation**, no waste and dust collect. Ideally suited for working overhead.
- Insert the insulation rolls from bottom to top and fix the surface felt to the rafters by stapling it laterally.
- The rolls can be cut to length by **tearing by hand** or with the **ISOLENA** cutting device.

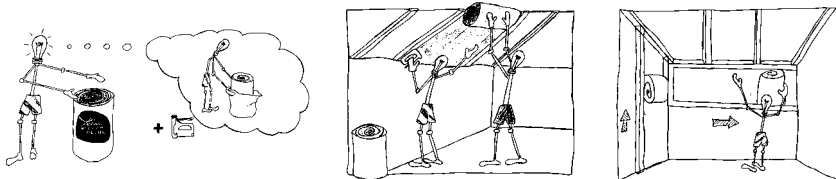

PROPERTIES



Sheep wool insulation



Air purification



Humidity regulation



Sound insulation
Fire protection



Sustainable



Wool protection



FORM OF DELIVERY

DIMENSIONS*

Width: 250 – 2.300 mm in 25 mm increments (250, 275, 300, 325, 350 mm,...)
Thickness: 20 – 80 mm in 10 mm increments (20, 30, 40, 50 mm,...)

Article	kg/m ³	Thickness (mm)	Width (mm)	Lengths (mm)	Item/PU	m ² /PU	PU/Pal	m ² /Pal
KF30	30	30	600	9.000	2	10,80	18	194,40
KF30	30	40	600	6.000	2	7,20	18	129,60
KF30	30	50	600	6.000	2	7,20	14	100,80
KF30	30	50	625	6.000	2	7,50	14	105,00
KF30	30	60	600	6.000	2	7,20	12	86,40
KF30	30	80	600	4.000	2	4,80	14	67,20

*Special sizes available from a minimum production quantity of one pallet approx. 4,85 m³ at no extra charge.



TECHNICAL DATA

European technical approval	ETA-07/0214						
Nature Plus®	0103-1006-099-1						
Thermal conductivity λ _{tr}	0,033 W/mK						
Vapour diffusion resistance factor μ	1						
Specific heat capacity c	1760 J/kgK						
Length-related flow resistance according to EN 29053	r = 10,2 kPa s/m ²						
Fire behaviour according to EN 13501-1	D-s2, d0; CH: RF3						
Degree of sound absorption with a thickness of 50 mm according to ISO 354	f [Hz]	125	250	500	1.000	2.000	4.000
	α _s	0,44	0,60	0,78	0,98	1,08	1,14
Assessed degree of sound absorption D. 50 mm according to ÖNORM EN ISO 11654	α _w = 0,85						
Mould growth intensity according to EN ISO 846	0						



ECOLOGICAL PARAMETERS

Compliant with the NaturePlus® Life cycle assessment **IOLENA**

Use of non-renewable primary energy without the non-renewable primary energy carriers used as raw material (PENRE [MJ, lower calorific value])	23,44	MJ/kg
Global warming potential Total of GHG emissions and CO ₂ storage (GWP 100 total)	0,83	kg CO ₂ -equiv./kg
Acidification potential of soil and water (AP)	4,63E-03	kg SO ₂ -equiv./kg
Potential for the formation of tropospheric ozone (POCP)	8,04E-04	kg C ₂ H ₄ -equiv./kg
Eutrophication potential (EP)	2,08E-03	kg PO ₄ ³⁻ -equiv./kg

